



Staveley Road, London, W4 3HU

Guide Price £1,850,000

**WHITMAN & CO.**

SALES · LETTINGS · COMMERCIAL



- Impressive detached house
- Sought after tree-lined residential road
- Off street-parking
- Five bedrooms
- Private 40' landscaped garden
- Great transport links

Tenure - Freehold  
Local Authority - Hounslow  
Council Tax - Band G

## THE PROPERTY

An immaculate five bedroom detached house offering an excellent balance of living and entertaining space in this sought after tree-lined residential road close to numerous amenities. This impressive property comprises a master bedroom with dressing room and ensuite, four further bedrooms, luxury family bathroom, additional shower room, large entrance hall, three reception rooms, fully integrated kitchen/breakfast room, utility room, dining room, study, cloak room, extensive storage throughout, private 40' landscaped garden and the added benefit of off-street parking. Ideally situated in the heart of Grove Park offering close proximity to parks, local shopping facilities and transport.

## SITUATION

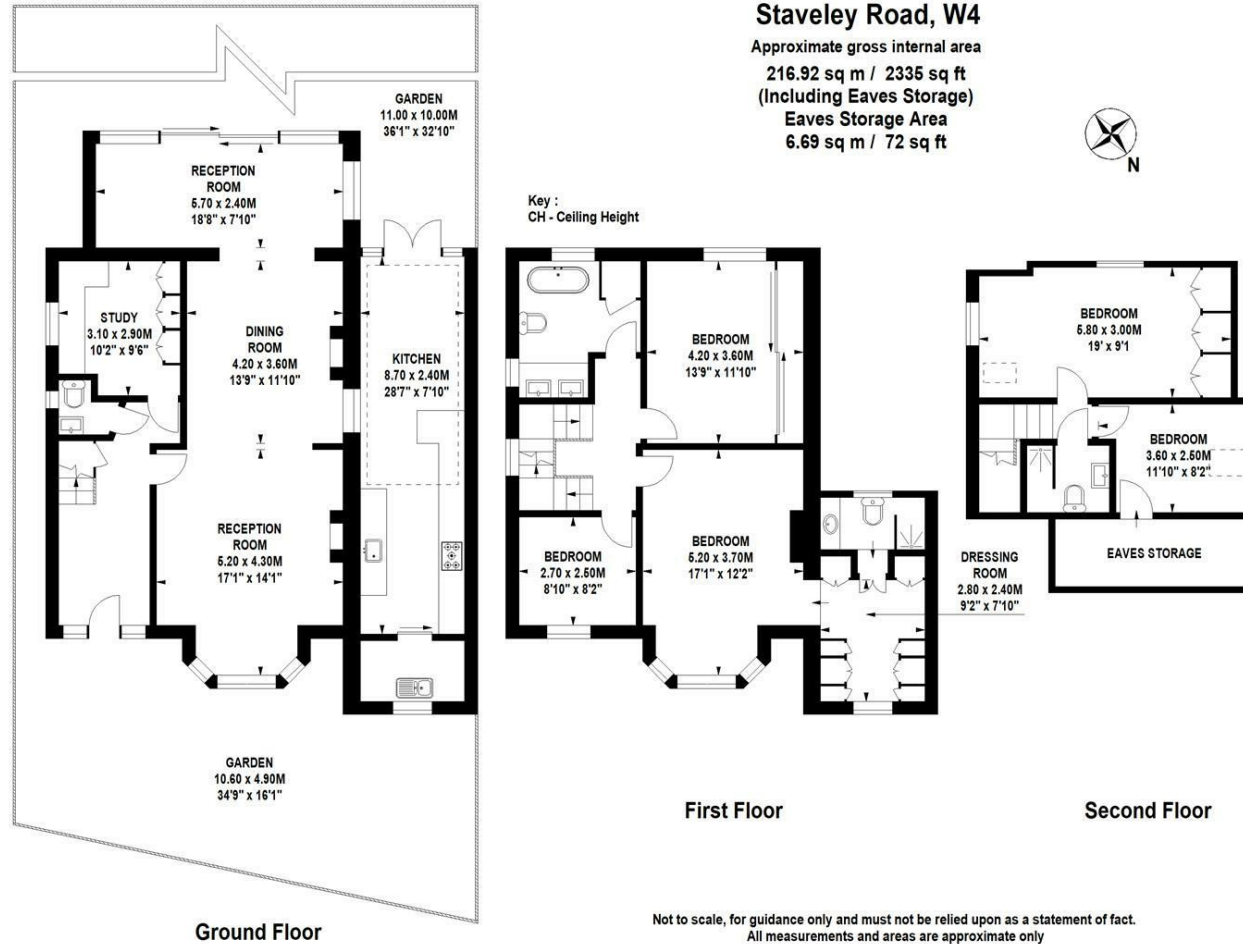
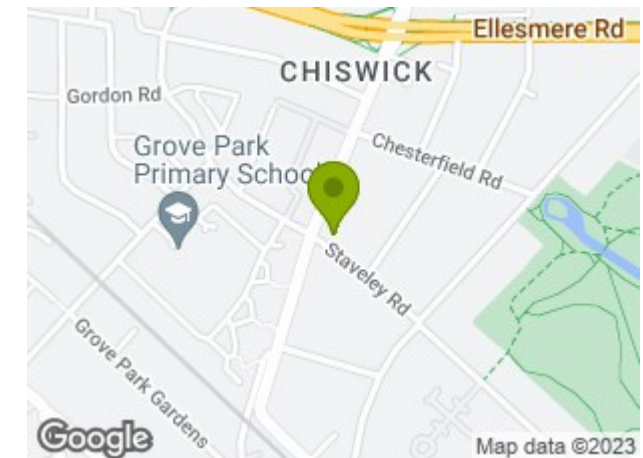

5-7 Turnham Green Terrace, Chiswick, London, W4 1RG

Tel 020 8747 8800

E-mail [sales@whitmanandco.com](mailto:sales@whitmanandco.com)

Website [www.whitmanandco.com](http://www.whitmanandco.com)